

2013 CONNIE'S CHATEAU



2013 PARADE HOME

8404 Passage Marseille Court, Raleigh, NC 27615

LaFayette

Heated square footage: 3,400

House Plan Designer: Midtown Designs

Marketing by: Raleigh Custom Realty

SPECIAL FEATURES

- 9 ft ceilings up and down
- Open floor plan
- Screened porch with fireplace
- Custom cabinets, high level granite
- Built-in flat screened TV
- 1st floor master, 2nd & 3rd bedrooms
- 3.5 inch red oak hardwood floors down
- Sealed conditioned crawl space
- HERS rated 3rd party- Live Green certified

DIRECTIONS From I-540, South on Falls of Neuse Rd. Right onto Walton Commons Dr. Left onto Rue Monet Dr. Right onto Passage Marseille Ct.

RALEIGH CUSTOM HOMES INC.

6736 Falls of Neuse Road, Suite 300 | Raleigh, NC 27615

Tim Thompson, owner

919.847.2664 office | 919.847.2665 fax

919.395.1529 cell

tim@raleighcustomhomes.net

www.raleighcustomhomes.com

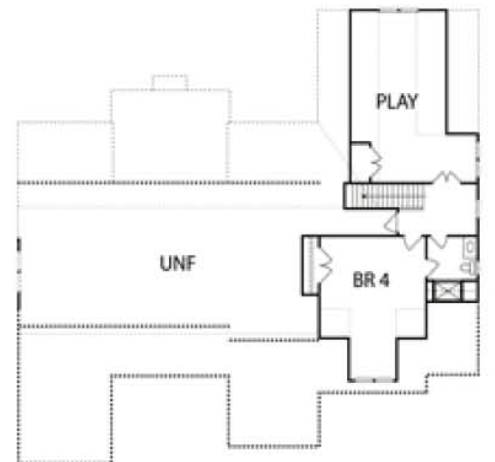

raleigh
CUSTOM HOMES